

REVISIONS				
REV	DATE	DRW'N	CHCK'D	DESCRIPTION
A	27APR16	CR	--	INITIAL RELEASE

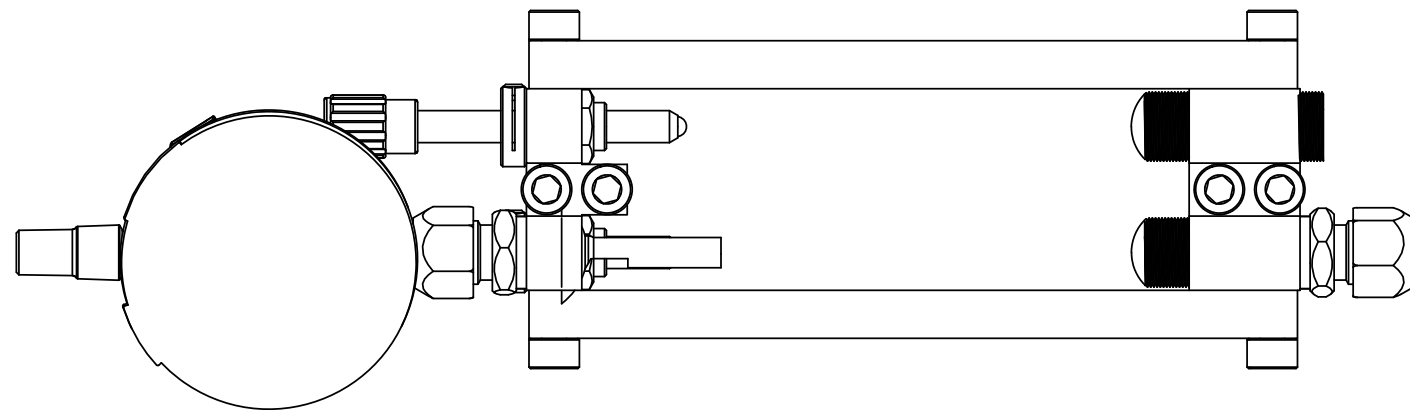
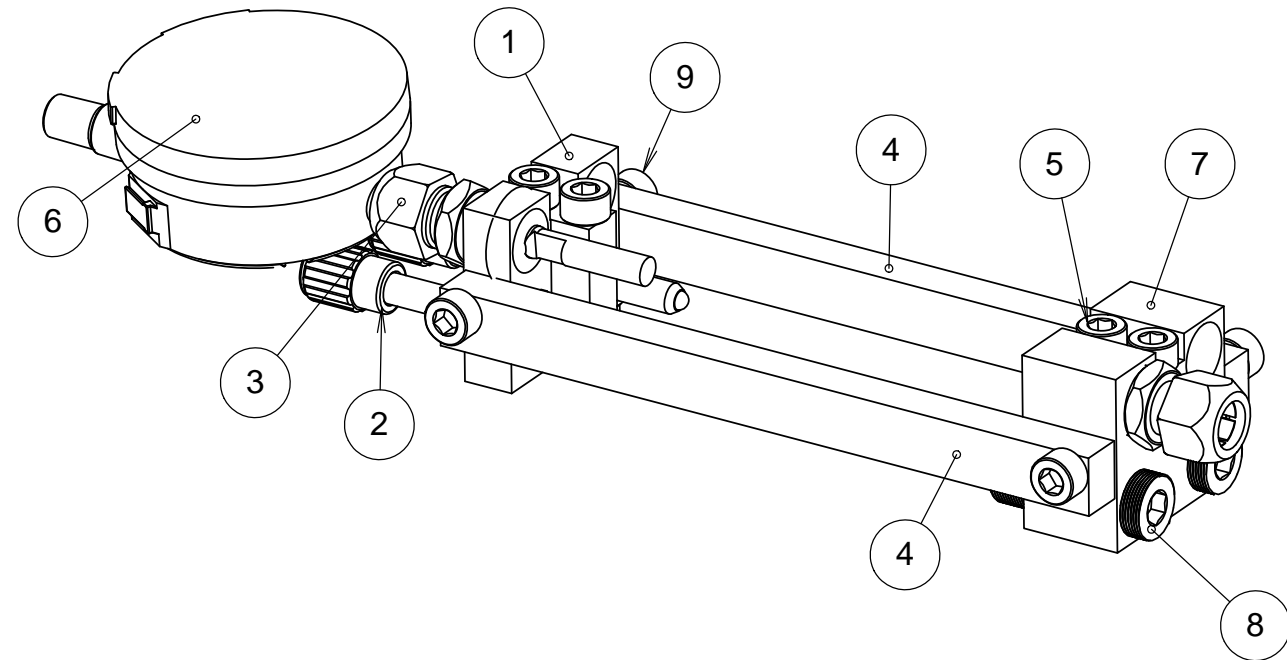

NOTES

- ASSEMBLY DRAWING SHOWN WITH BOTH .535-40 JACKING SCREWS AND 100TPI JACKING SCREWS FROM NEWPORT. IN PRACTICE, ONLY ONE OR THE OTHER WILL LIKELY BE USED. THE 100TPI WILL GIVE THE RESOLUTION WE WANT, BUT MAY HAVE INSUFFICIENT THRUST FORCE CAPACITY.

ITEM NO.	PartNo	DESCRIPTION	QTY.
1	872-LM8214	ADJUSTOR BLOCK BASE A	1
2	NEWPORT AJS100-1	100 TPI ADJUSTOR	2
3	20665A48	COLLET, 9/16-18 FOR 3/8 SHAFT, MMC	2
4	872-LM8216	LATERAL BRACE, V-BLOCK ADJUSTOR	2
5	MC_SHCS_M6X35_9129 0A202	SHCS M6X35 BLACK OXIDE	4
6	MC_20835A22	MITUTOYO DIGITAL DIAL INDICATOR, 543-793B	1
7	872-LM8213	V-BLOCK ADJUSTOR BASE	1
8	872-LM8215	JACKING SCREW, .535-40	2
9	MC_SHCS_M6X18_9150 2A166	SOCKET HEAD CAP SCREW, M6X18	4

UNLESS OTHERWISE NOTED DIMENSIONS ARE IN INCHES & TOLERANCES ARE AS FOLLOWS
 X.X: ±0.1000" X.XX: ±0.0100"
 X.XXX: ±0.0050" X.XXXX: ±0.0001"
 ANGLES: ±0.5° FINISH: 125 MICRO INCHES
 BREAK ALL SHARP EDGES & CORNERS .002" MAX

MATERIAL	FINISH
PARTS LIST	NA



DRAWN	C.RATLIFF	--	PROJECT CODE	K1D3FD	DWG NO	872-LM-8217	A 1/1
CHECKED	--	--	TITLE	V-BLOCK ADJUSTOR ASSY			
DESIGNED	C.RATLIFF	--	SW DOCUMENT FILE				
ENGINEER	--	--	NEXT ASSY	--			