

REVISIONS				
REV	DATE	DRW'N	CHCK'D	DESCRIPTION
A	22SEP17	GFC	--	INITIAL RELEASE
B	06OCT17	GFC	--	MATERIAL & DESIGN CHANGE
C	20OCT17	GFC	SP(KECK)	DIMENSION CHANGE

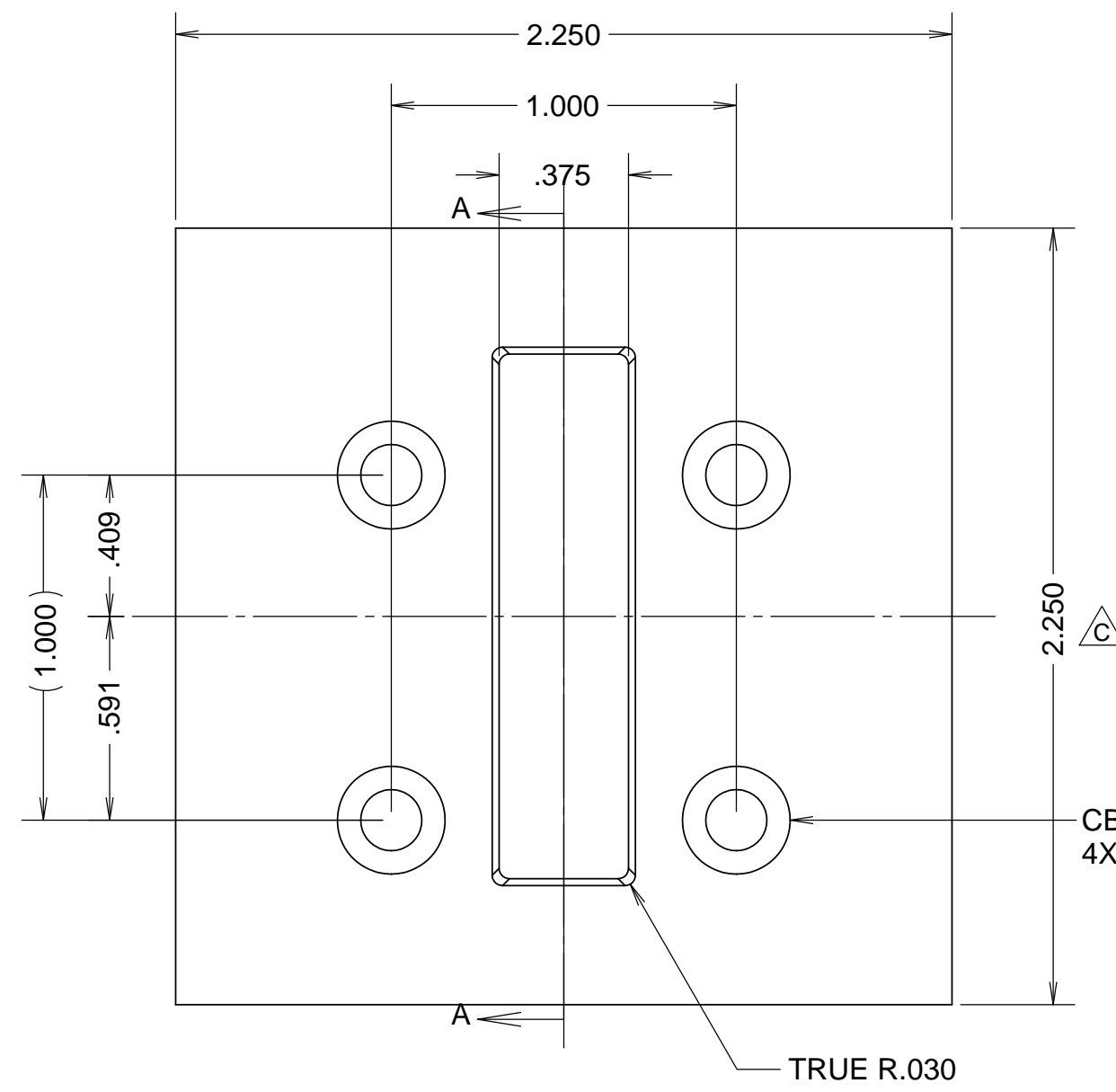

CBORE FOR #8 SOCKET HEAD CAP SCREW  
 4X  $\phi$  .177  $\nabla$  .490 -  $\square$   $\phi$  .313  $\nabla$  .164

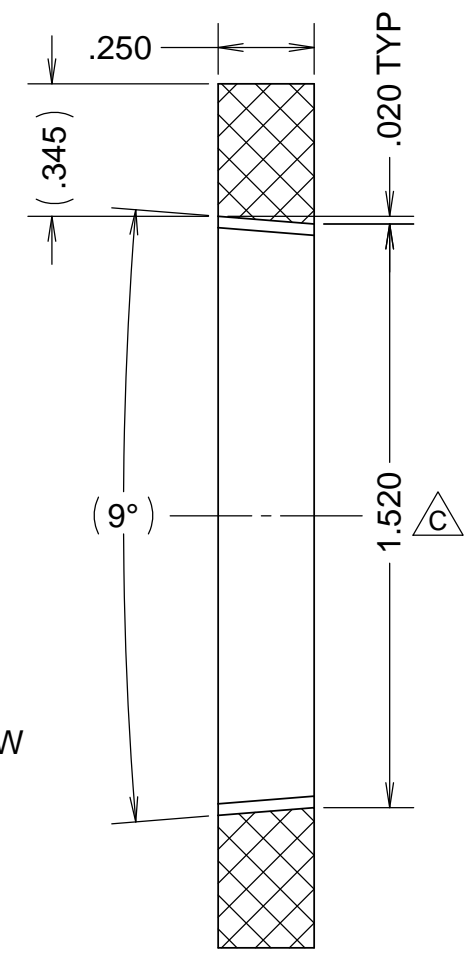

SECTION A-A

**NOTES**

- 1 CAD MODEL FILENAME, 872-LM6007 GuidePlate
- 2 BLACK ANODIZE OR AEROGLAZE PAINT PER MANUFACTURER'S SPECS

UNLESS OTHERWISE NOTED DIMENSIONS ARE IN INCHES & TOLERANCES ARE AS FOLLOWS

X.X:  $\pm 0.1000''$  X.XX:  $\pm 0.0100''$   
 X.XXX:  $\pm 0.0050''$  X.XXXX:  $\pm 0.0001''$   
 ANGLES:  $\pm 0.5^\circ$  FINISH: 125 MICRO INCHES  
 BREAK ALL SHARP EDGES & CORNERS .002" MAX

MATERIAL	FINISH	
5XXX/6XXX AL	64	2

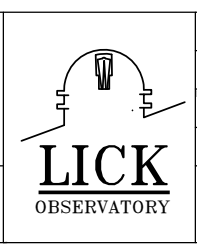

DRAWN	CABAK	--	KECK 1 DEPLOYABLE TERTIARY MIRROR
CHECKED	--	--	TOWER DOCKING
DESIGNED	CABAK	--	TITLE
ARCHITECT	CABAK	--	GUIDE PLATE
SW DOCUMENT FILE	1	PROJECT CODE	K1D3FD
		DWG NO	872-LM6007
		NEXT ASSY	--
			C 1/1