

REVISIONS				
REV	DATE	DRW'N	CHCK'D	DESCRIPTION
A	27MAR17	CR	--	INITIAL RELEASE

2X  $\phi$  8.433 THRU ALL  
3/8-24 UNF THRU ALL

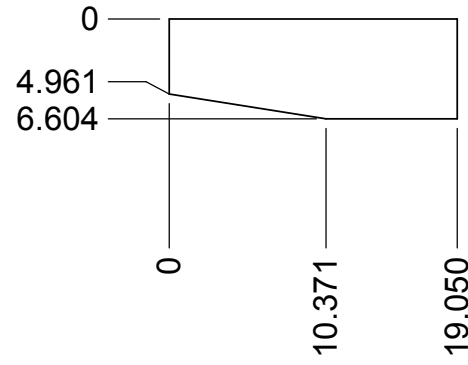
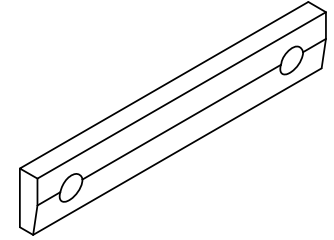
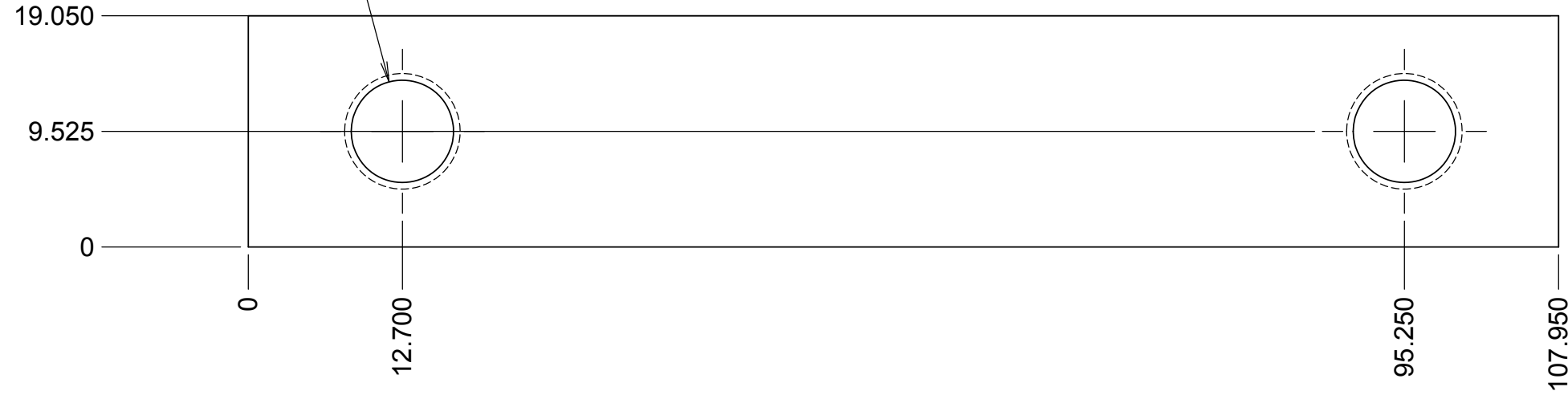

**NOTES**

- CAD MODEL FILENAME, 872-LM3199 Seismic Mount Nut Plate A
- MATERIAL: STAINLESS STEEL

UNLESS OTHERWISE NOTED DIMENSIONS ARE IN MILLIMETERS & TOLERANCES ARE AS FOLLOWS: X.X: ±0.10 mm X.XX: ±0.01 mm ANGLES: ±0.5° FINISH: 3 MICRONS (µm) BREAK ALL SHARP EDGES & CORNERS .25mm MAX			DRAWN <b>RATLIFF</b>	--	KECK 1 DEPLOYABLE TERTIARY MIRROR	
SEE NOTE 2.			FINISH <b>NA</b>	CHECKED <b>JW</b>	--	OUTER DRUM
			DESIGNED <b>JW</b>	--	TITLE <b>SEISMIC MOUNT NUT PLATE A</b>	
			ENGINEER <b>RATLIFF</b>	--	QUANTITY <b>1</b>	PROJECT CODE <b>K1D3FD</b>
			SW DOCUMENT FILE 872-LM3199 Seismic Mount Nut Plate A.SLDPRT		NEXT ASSY --	DWG NO <b>872-LM3199</b>
						REV <b>A</b>
						<b>1</b>