

4

3

2

1

REV	DRWN	CHK'D	DATE	DESCRIPTION
A	GFC	TP	10/10/02	INITIAL RELEASE
B	GFC	GFC	11/27/02	ADDED HANDLES
C	GFC	GFC	12/2/02	ADDED ITEM 4 & NOTE 2
D	GFC	TP	12/5/02	REPLACED FHMS & THUMB NUT WITH ITEMS 10, 11, & 12
E	GFC	TP	1/14/03	REPLACED ITEMS 2, 5, 6, & 7; DELETED NOTE 2
F	GFC	JL/TP	1/16/04	SIMPLIFIED; ELIMINATED ITEM 9

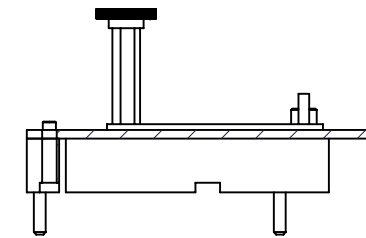
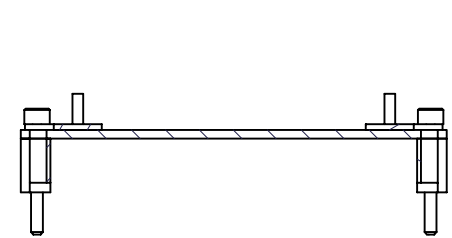
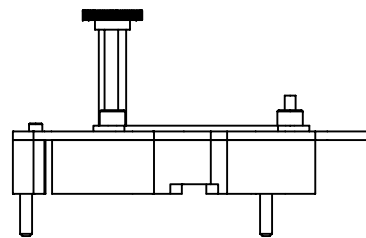
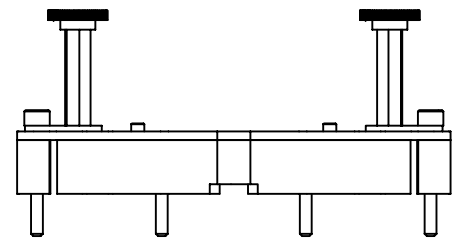
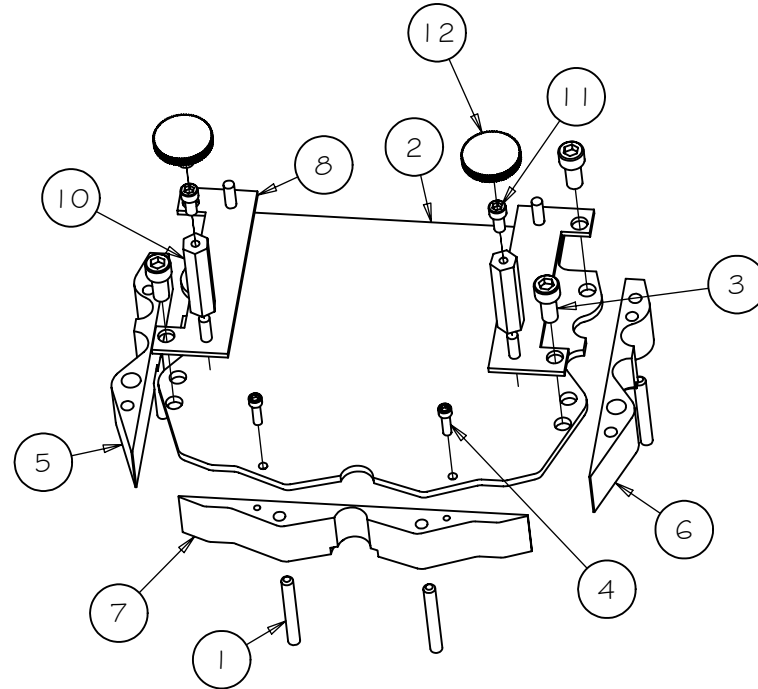
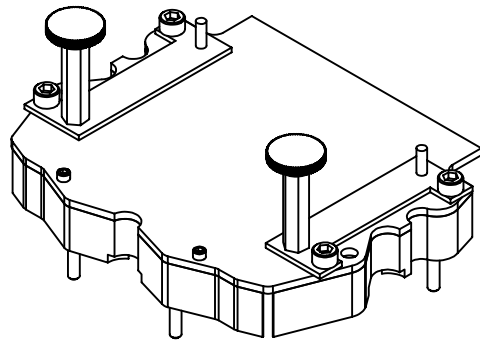
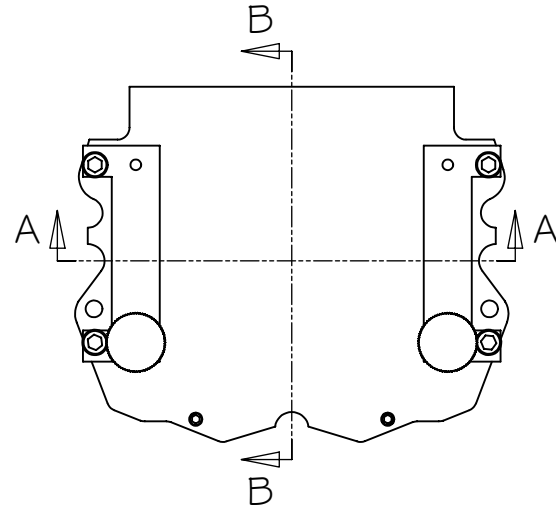

SECTION A-A

SECTION B-B

Parts List			
ITEM	QTY	PART NUMB	DESCRIPTION
1	4	H-9416	PIN, SPLASH GUARD
2	1	H-9428	PLATE, SPLASH GUARD
3	4	H/W	SCREW, SHCS, 8-32 x .375
4	2	H/W	SCREW, SHCS, 2-56 x .3125
5	1	H-9429	BASE, GETTER SIDE, SPLASH GUARD
6	1	H-9430	BASE, OPPOSITE SIDE, SPLASH GUARD
7	1	H-9431	BASE, CENTER, SPLASH GUARD
8	2	H-9425	HANDLE BASE, SPLASH GUARD
10	2	H/W	STANDOFF, .25 HEX x 4-40 THRU
11	2	H/W	SCREW, SHCS, 4-40 x .25
12	2	H/W	KNOB, FOR 4-40 SHCS

NOTES

1 PRESS FIT PINTS (ITEM 2) SO THAT END IS FLUSH WITH TOP SURFACE OF BASE (ITEMS 5, 6, & 7)

TOLERANCES UNLESS OTHERWISE NOTED:
 FRACTIONAL: 0"-6": ±1/64" 6"-24": ±1/32"
 24"+: ±1/16"
 DECIMAL: X.X: ±0.1000" X.XX: ±0.0100"
 X.XXX: ±0.0050" X.XXXX: ±0.0001"
 ANGLES: ±0.5° FINISH: 125 MICRO INCHES
 BREAK ALL SHARP EDGES & CORNERS 1/64" MAX

MATERIAL	FINISH
PARTS LIST	



DRAWN	G CABAK	10/10/2002
CHECKED	T PFISTER	10/10/2002
DESIGNED	G CABAK	
ENGINEER	G CABAK	10/10/2002

DO NOT SCALE DRAWING

PROJECT CODE		DWG NO		REV
KHCCDE		H-9413		F
NEXT ASSY				1/1
H-9111				

4

3

2

1